

High Power Polarization Independent Optical Isolator 1050, 1053±50nm

The 1050, 1053nm High Power Broadband Polarization Independent (Polarization Insensitive) Optical Fiber Isolator is an in-line pigtailed micro-optic component allows light to be transmitted only in the forward direction while blocking the backward transmission. It features wide operating wavelength, low insertion loss and high power handling . The isolators are commonly used to protect lasers or amplifiers against back-reflected light.

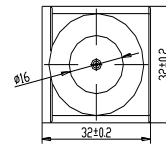
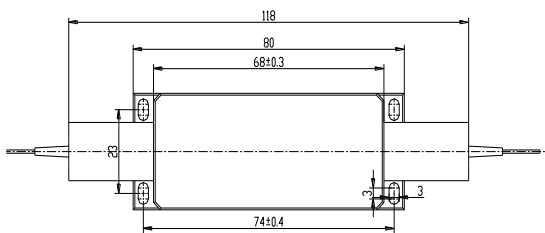

Features

- High Isolation
- Low Insertion Loss
- Broadband
- High Power Handling

Applications

- Fiber Amplifier
- Fiber Laser
- Fiber Sensor
- Lab & Research

Performance Specification

Parameter	Value	Unit
Center Wavelength	1050, 1053 or customized	nm
Bandwidth	±50	nm
Typ. Peak Isolation	33	dB
Min. Isolation at 23°C	26	dB
Typ. Insertion Loss at 23°C	1.0	dB
Max. Insertion Loss at -5 to 50°C	1.5	dB
Max. PDL at 23°C	0.15	dB
Min. Return Loss	50	dB
Max. Optical Power (Continuous Wave)	1, 3, 5, 10, 15, 20	W
Max. Tensile Load	5	N
Fiber Type	HI 1060 fiber or LMA Fiber	
Operating Temperature	-5 to +50	°C
Storage Temperature	-40 to +85	°C
Package Dimension		mm

Note

- * For pulse applications, pls discuss with OF-LINK.
- * Don't add connectors for isolator more than CW 1W.

Ordering Information

HPBI-AAAA-BB-C-DD-EE-FF

AAAA	BB	C	DD	EE	FF
Wavelength	Fiber Type	Fiber Jacket	Fiber Length	Connector	Power
1050 - 1050nm	H6 - HI 1060 Fiber	B - 250um Bare	05 - 0.5m	NE - None	01 - 1W
1053 - 1053nm	LM - LMA Fiber	Fiber	08 - 0.8m		03 - 3W
SSSS - Specify	SS - Specify	L - 900um Loose	10 - 1.0m		05 - 5W
		Tube	15 - 1.5m		10 - 10W
			SS - Specify		15 - 15W
					20 - 20W
					SS - Specify